

FOXCONN IN WISCONSIN

BUILDING FOR THE FUTURE



LAND ACQUISITION UPDATE

By The Numbers

100% **CORE OF AREA 1**

Taking the core area of Area I, which will be home to the first phase of Foxconn's manufacturing campus, the **Village has acquired 100% of the land.**

97% **AREA 1**

Taking Area I in its entirety (East Frontage Road to CTH H and Braun Road to CTH KR), the **Village has acquired about 97% of the land, pending closings.**

82% **FOXCONN PROJECT AREA**

Taking the entire Foxconn Project Areas, Areas I, II and III, the **Village has acquired approximately 82% of the land, pending closings.**



DEMOLITION WORK

- **Demolition work tied to the Foxconn project continues**
- The Village awarded a **third contract** to Fond du Lac County-based Guelig Waste Removal and Demolition LLC for demo work
 - Building demolition along County H, from Highway 11 to County Highway KR
- **All three subcontractors are from Wisconsin**
 - KPH Construction, Milwaukee
 - Krizan's Well Drilling, Union Grove
 - Pat's Services, Inc., Burlington



INTERGOVERNMENTAL AGREEMENT

- On Thursday, the Mount Pleasant Village Board **approved an Intergovernmental Agreement** between the City of Racine, Racine Water Utility and the Village
- The Agreement does the following:
 - **Protects City and Village taxpayers** by ensuring that water infrastructure improvement costs are funded through Foxconn's \$10 billion investment in TID 5
 - Guarantees Utility ratepayers will have **no increased costs**
 - Increases **public safety funding** to the City of Racine
 - Increases **transit funding** to the City of Racine
 - **Reduces REC fees** from \$3,623 to \$500



WISCONN VALLEY

Trucking Coordination

BRETT WALLACE

AUGUST 20, 2018



WISCONN VALLEY TRUCK COORDINATION

- The Wisconsin Department of Transportation (WisDOT) is responsible charge of safe and efficient transporting of materials used to construct I-94 and the Wisconn Valley development roadways.
- WisDOT is acting as a resource to coordinate trucking and access in the development area.



WISCONN VALLEY TRUCK COORDINATION

Focus areas:

1. Weekly hauling access memo (WHAM)
2. Signage
3. Enforcement
4. Communication



WEEKLY HAULING MEMO

Goal: Provide a comprehensive review of planned truck routing and volume.

- Inform law enforcement, project owners, contractors, DPWs and local officials on a weekly basis what routes are being utilized and how.
- Increase safety and predictability of hauling materials to the development and all the infrastructure projects in the area.
- Help ensure the right trucks are using pre-approved routes.

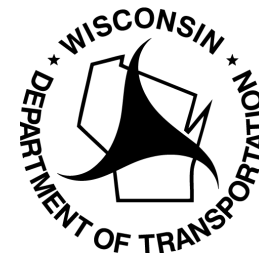

WEEKLY HAULING MEMO

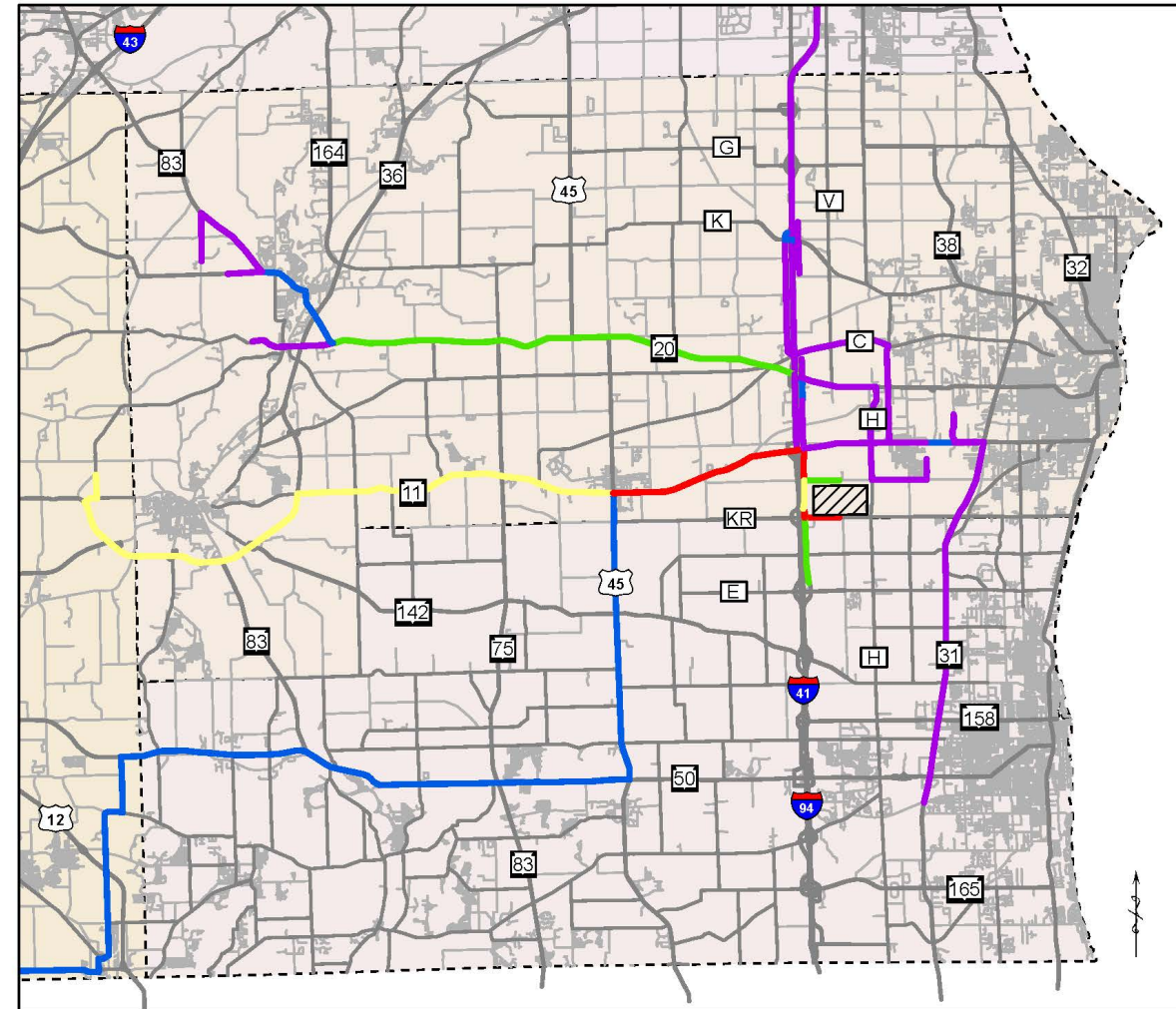
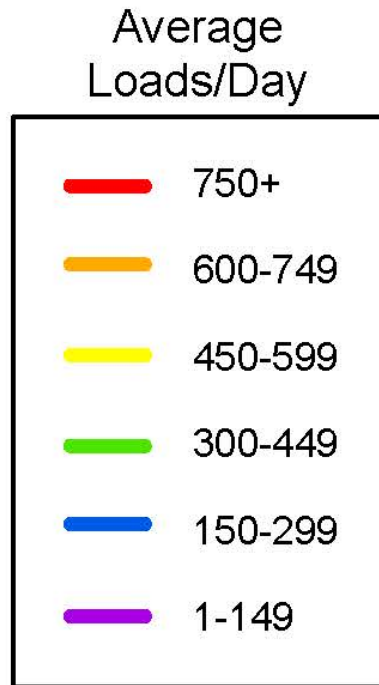

WISCONN VALLEY TRUCK SIGNAGE

Goal: Provide signage to help coordinate high volume trucking and access



WISCONN VALLEY TRUCK SIGNAGE

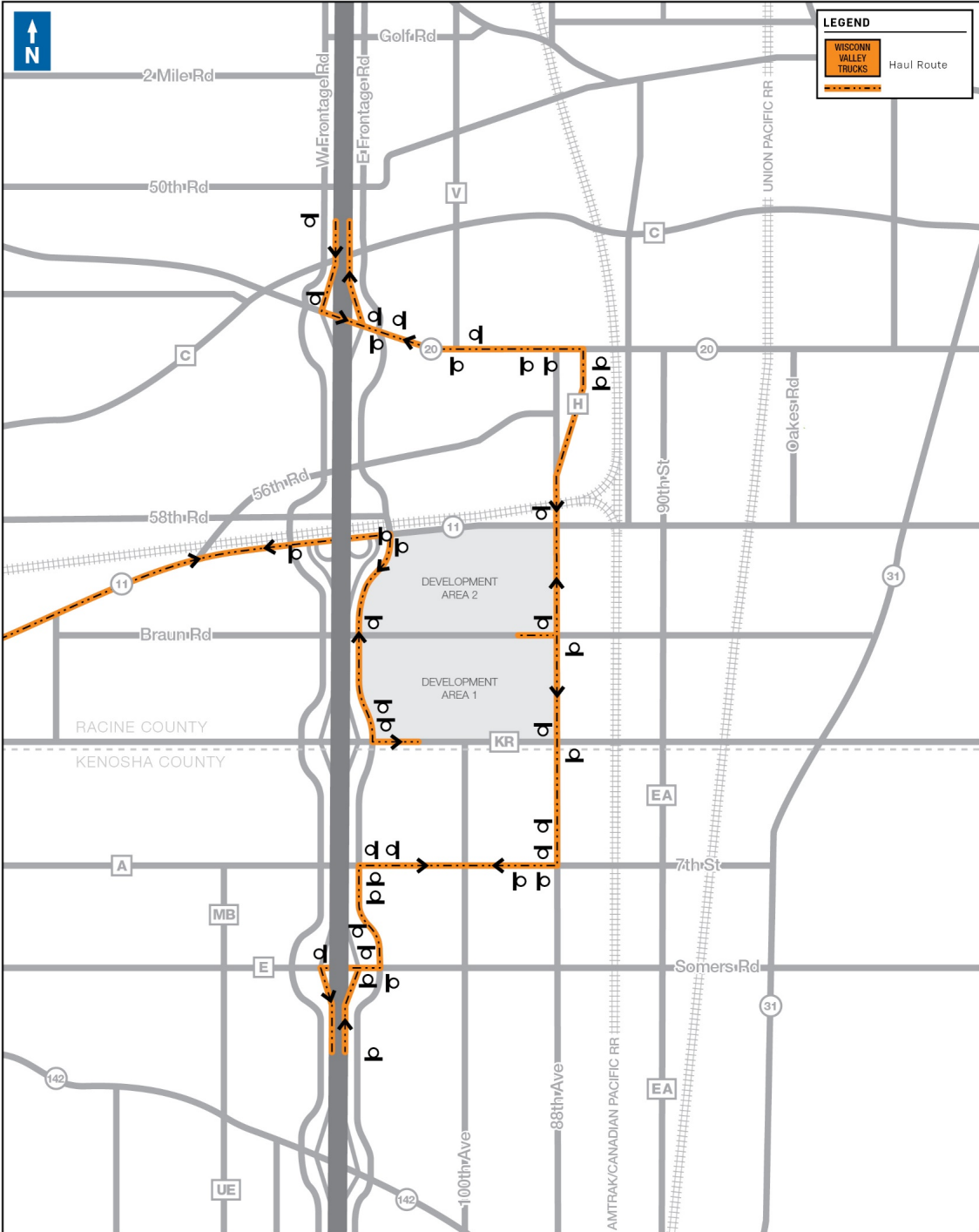

WISCONN VALLEY TRUCK SIGNAGE

Contractor
for
WisDOT



Contractor
for
Wisconn Valley
Development



Contractor
for
Utilities



- Blue truck placards for WisDOT contractors.
- Orange truck placards for Wisconn Valley Development contractors.
- Green truck placards for utilities contractors.



WISCONN VALLEY TRUCK SIGNAGE



- State and local coordination is ongoing to sign routes that are not as appropriate for trucks.
- Local law enforcement will assist in managing these.



ENFORCEMENT

Goal: Conduct safe trucking operations.

- WisDOT's Division of State Patrol will assist to:
 - Perform random weight enforcement at several locations
 - Conduct safety checks on the truck and driver to ensure trucking is done in a safe manner.
- WisDOT project team weekly traffic meeting:
 - Review proposed lane and ramp closures with emergency responders, DPWs, municipalities to identify issues.





Wisconsin Plan 94

Published by Emlynn Grisar [?] · August 10 at 9:23 PM · 🌐

WisDOT manages the safe and efficient transporting of materials used to construct I-94 and the Wisconn Valley roadways. NEW THIS WEEKEND: You'll see these orange signs as we work to coordinate the larger trucking needs and access in and around the development zones.



👤 3,054 people reached

Boost Post

COMMUNICATION

Goal: Further inform stakeholders on trucking and work zone operations.

- Web site
- Social media
- Monthly public infrastructure meetings

HAULING AND ACCESS MAPS

LEGEND

●●●● Freeway or development road construction

ACCESS ROUTES

—○— General access route (Wisconn Valley workers)

—●— Wisconn Valley haul route
Return trips to the west shall use the controlled intersection at County H/WIS 11

—■— Open to traffic; closed to Wisconn Valley trucks

CLOSURES

—■— Roadway closed (under I-94 mainline)

—■— Ramp closed (I-94 entrance/exit)

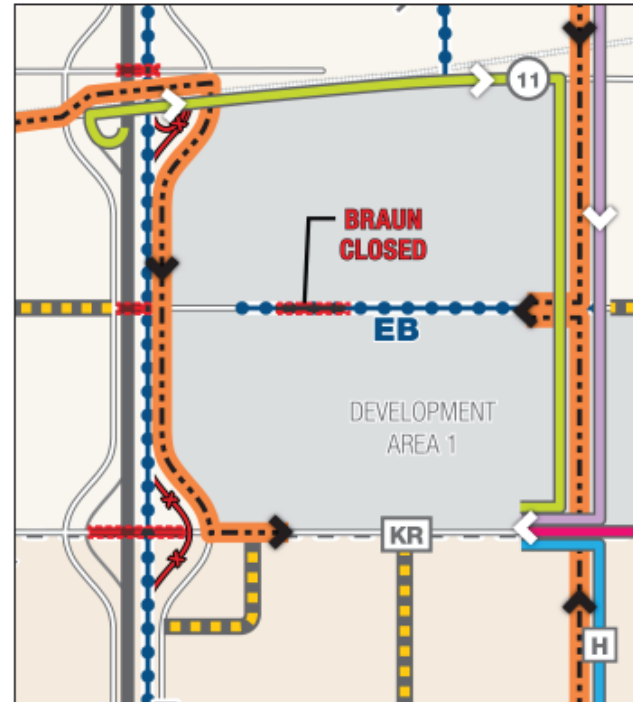

HAULING AND ACCESS MAPS

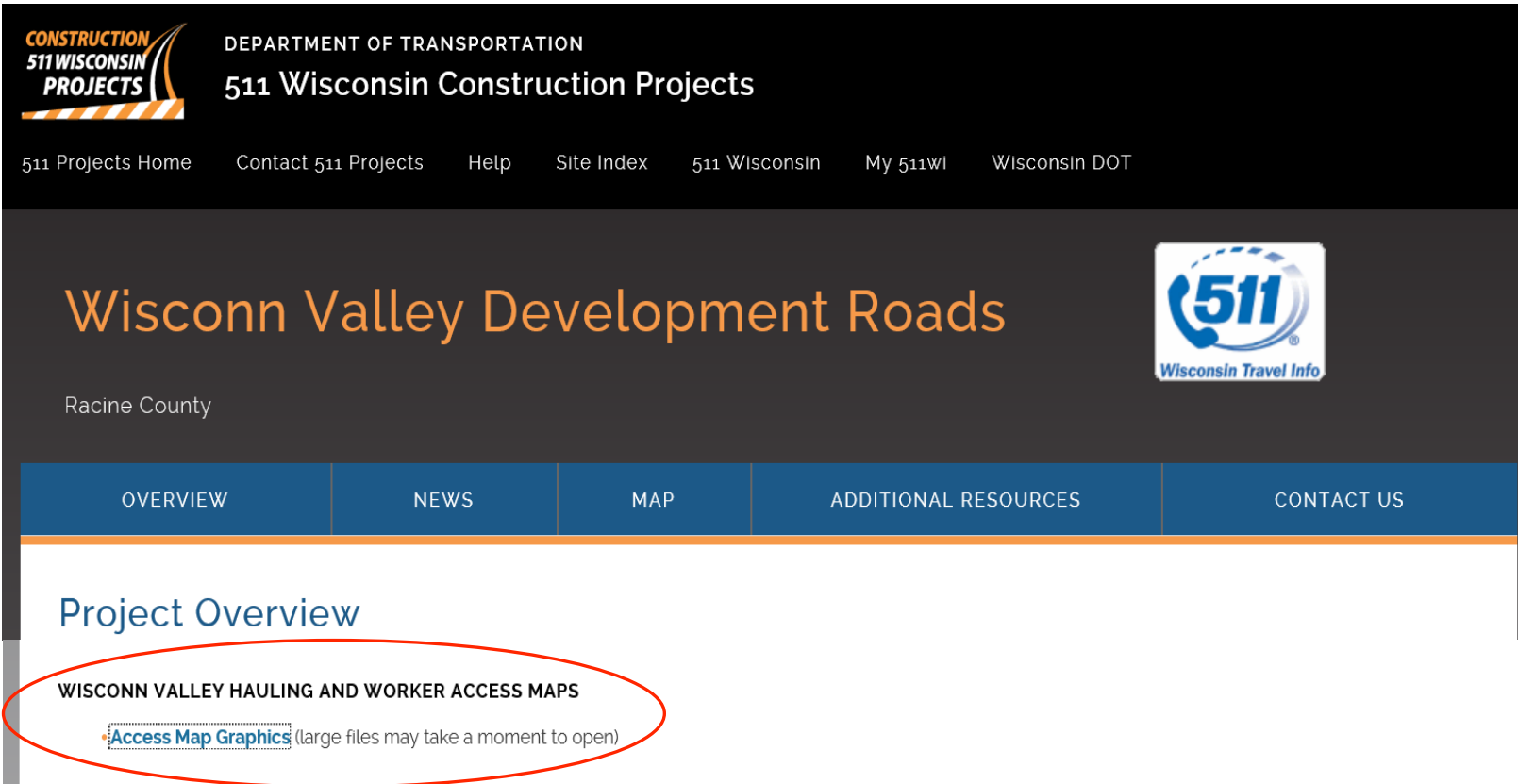

The screenshot shows the website for the Department of Transportation's 511 Wisconsin Construction Projects. The header includes the logo and navigation links. The main content area displays the project title 'Wisconn Valley Development Roads' for Racine County, with a '511 Wisconsin Travel Info' logo. A navigation bar contains links for Overview, News, Map, Additional Resources, and Contact Us. The 'Project Overview' section is visible, featuring a link to 'WISCONN VALLEY HAULING AND WORKER ACCESS MAPS' and a sub-link 'Access Map Graphics' which is circled in red. A note indicates that large files may take a moment to open.

CONSTRUCTION 511 WISCONSIN PROJECTS

DEPARTMENT OF TRANSPORTATION
511 Wisconsin Construction Projects

511 Projects Home Contact 511 Projects Help Site Index 511 Wisconsin My 511WI Wisconsin DOT

Wisconn Valley Development Roads

Racine County

511 Wisconsin Travel Info

OVERVIEW NEWS MAP ADDITIONAL RESOURCES CONTACT US

Project Overview

WISCONN VALLEY HAULING AND WORKER ACCESS MAPS

[Access Map Graphics](#) (large files may take a moment to open)

Visit:

[https://projects.511wi.gov/fdr/
full-project-overview/](https://projects.511wi.gov/fdr/full-project-overview/)



STAY CONNECTED



WISCONN VALLEY NEWS

The Wisconn Valley News is published every other week and designed to keep interested individuals up to date on Foxconn construction plans, infrastructure improvements, traffic pattern updates, and more. Local elected officials, suppliers, contractors and members of the public are encouraged to turn to the Wisconn Valley News for the latest project status, road updates, next steps, and interesting facts. When appropriate, special bulletins will also be distributed to ensure the most timely information possible.



Project Status

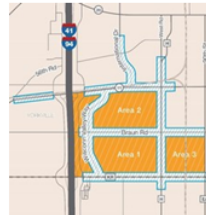

In November, Governor Scott Walker and Foxconn Chairman Terry Gou signed an agreement to bring a \$10 billion world-class advanced manufacturing campus and 13,000 jobs to Wisconsin. This project, called Wisconn Valley, is a once-in-a-lifetime opportunity, expected to have a transformational effect on our entire state.

Following the signed contract, Foxconn Technology Group deposited \$60 million to purchase land in Mount Pleasant between WIS 11 and County KR. The project is underway and work is moving forward to create a campus that will build 7 million LCD units a year in Wisconsin. Foxconn is finalizing the design and construction plans for the campus, while state and local governments are working to finalize plans for water, sewer, and roadways.

To keep the project on time, two infrastructure projects were advanced. Hoffman Construction, of Black River Falls, was awarded a contract by the Wisconsin Department of Transportation to reconstruct a North-South frontage road along I-94 between County KR and WIS 20, to help manage traffic flow in the project area. Advance Construction Inc., of Green Bay, was awarded a contract by the Racine Water Utility to begin water main work on County Highway H adjacent to the development area. These projects represent a small fraction of the overall infrastructure work to be completed.

While most of projects related to Foxconn have not yet come out for bid, information will be shared when opportunities for bids become available in the future.



projects.511wi.gov/



twitter.com/WisconsinPlan94



facebook.com/WisconsinPlan94

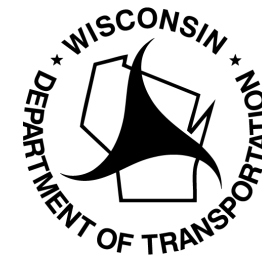



August 20, 2018
Mount Pleasant Civic Campus

Wisconn Valley: Expanding Opportunities

Community Forum Presentation

William Martin

Director
Strategic Workforce Development Initiatives

Department of Workforce Development

Expanding Business Opportunities

- State, Foxconn, Village of Mount Pleasant & City of Racine committed to Wisconsin First goals
- 10% goal for Racine County-based business engagement with Wisconn Valley construction projects
- 10% goal for targeted businesses
- Launched series to share support for business certifications, training, wage subsidies & tax credits
- Next session: August 24th, 8:00 a.m.-11:00 a.m. at S.C. Johnson iMet Center, Sturtevant
- To attend, please register at: <https://www.surveymonkey.com/r/CapacityBuildingWI>



Expanding Workforce Opportunities

OPPORTUNITY:

- Foxconn will kick off 3 million square feet of construction in early 2019

CHALLENGE:

- Under 3% unemployment for last several months—lowest unemployment rates in state's history
- Aging skilled trades workforce (nearly 1 in 6 is 55 years of age or older)
- Retirements continue to accelerate

STRATEGY:

- Expand the workforce by attracting previously underemployed/underrepresented residents

Expanding Workforce Opportunities

WISCONSIN FIRST WORKFORCE TRAINING CENTER & WISCONN VALLEY TALENT ATTRACTION PIPELINE

- Governor Walker, DWD, Foxconn & M+W/Gilbane announced onsite training commitment combined with a public-private talent pipeline of qualified candidates



Expanding Workforce Opportunities

WISCONSIN FIRST WORKFORCE TRAINING CENTER & WISCONN VALLEY TALENT ATTRACTION PIPELINE

DWD will:

- Meet with contractors in Pre-Bid and Post-Award sessions
- Serve as liaison between contractors and public state and locally led workforce development programs

Workforce Coalition will:

- Recruit & pre-screen candidates
- Coordinate initial training (e.g., pre-apprenticeship, etc.) & specialized training
- Provide new hire support and follow
- Assist employers with wage subsidies, fidelity bonding, tax credits for hiring underemployed, target populations

Questions?

William Martin

Director-Strategic Workforce Development Initiatives

<http://dwd.wisconsin.gov>

William2.Martin@DWD.Wisconsin.gov

