

FOXCONN IN WISCONSIN

BUILDING FOR THE FUTURE



HOUSING SUMMIT

- Last week, Racine County and the Wisconsin Housing and Economic Development Authority (WHEDA) hosted a **Southeastern Wisconsin Housing Summit**.
- Municipal leaders, community leaders, housing developers, builders and financial institutions came together to **discuss housing solutions for the region as it continues to grow**.
- Goals:
 - **Position municipalities in Racine County to attract new workers to live here** as well as work here – resulting in greater economic benefits for the region; and
 - Lead growth strategically, **in the right way**.



VERTICAL CONSTRUCTION UNDERWAY

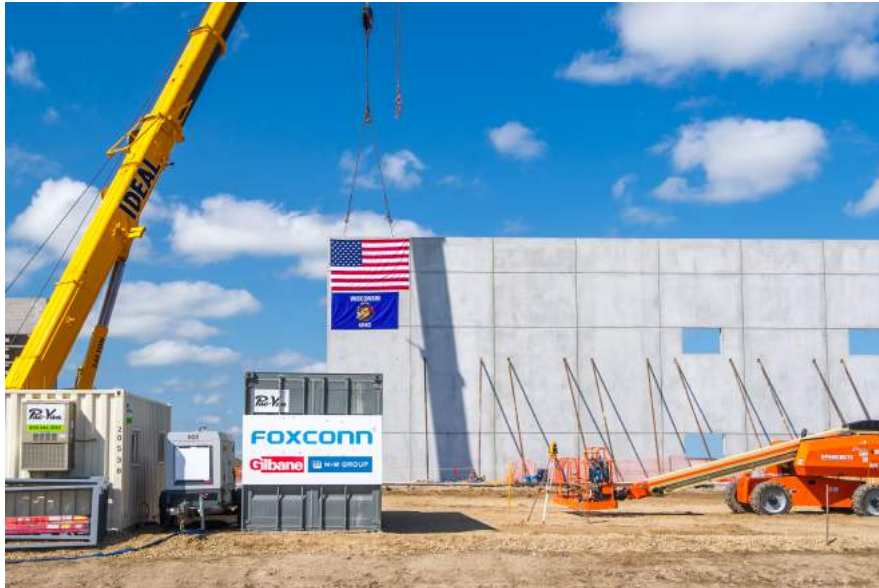

WISCONN VALLEY RENDERING VIDEO



VILLAGE BIDS FOR WORK ASSOCIATED WITH FOXCONN

- TID #5 Sanitary Sewer System – Phase 1
 - Work will include **construction of sanitary sewer improvements**, traffic control, erosion control surface restoration and miscellaneous related work.
 - Bids due Wednesday, September 19 at 2:00 PM.
- 16th Street Reconstruction – Oakes Road to Green Bay Road & 16th Street Transmission Water Main Relay
 - Submissions closed on Thursday, September 6.
 - Work will include pavement sawcutting, pavement and storm sewer removals, water main and storm sewer installation, etc.
 - **Anticipated contract award date: Tuesday, October 2.**



Project Update

Foxconn's Industrial Construction Work in Phase 1 of Area 1
of Wisconn Valley Science & Technology Park

September 2018



Site Areas



Phase 1, Area 1 Master Plan

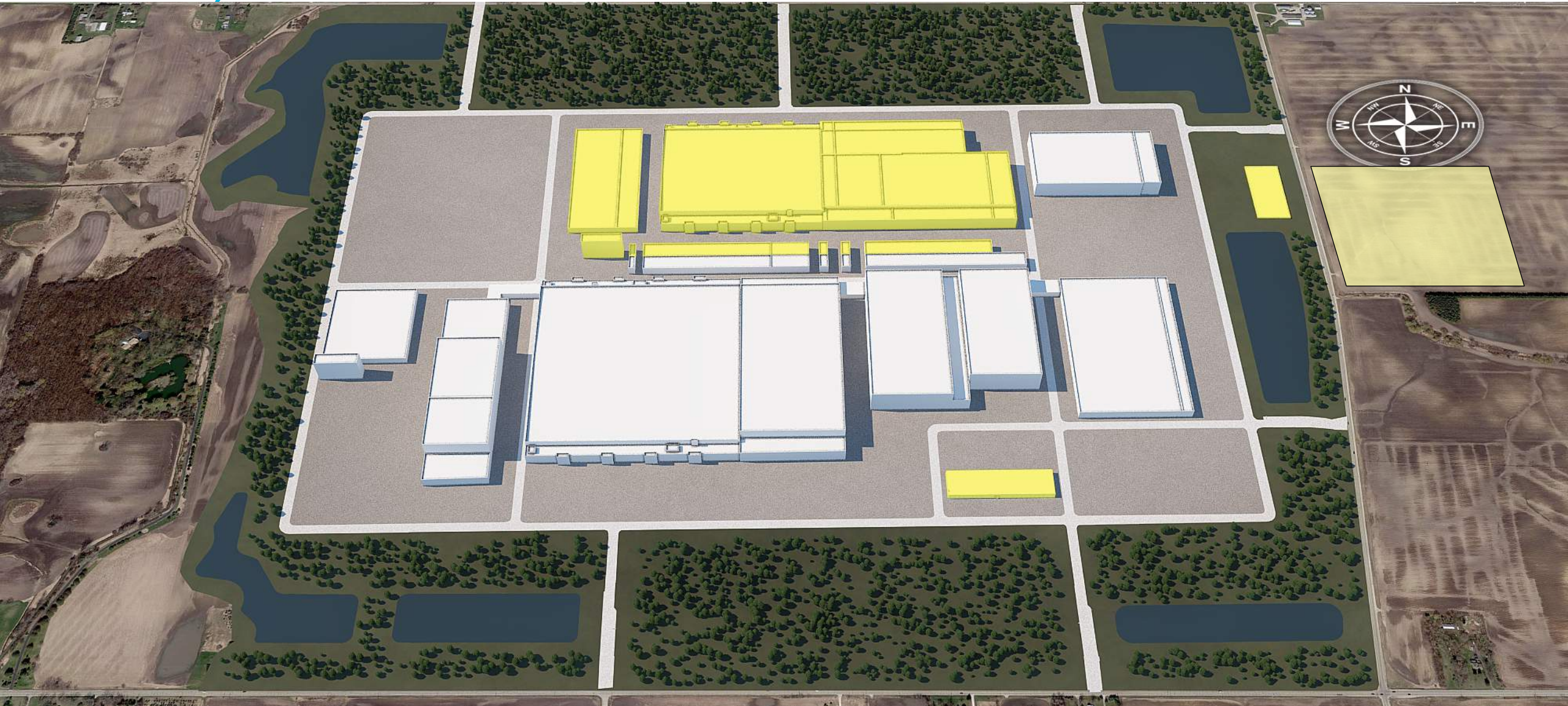

Site Development of Master Plan



Multipurpose Building Work

- 120,000 Square Feet Facility

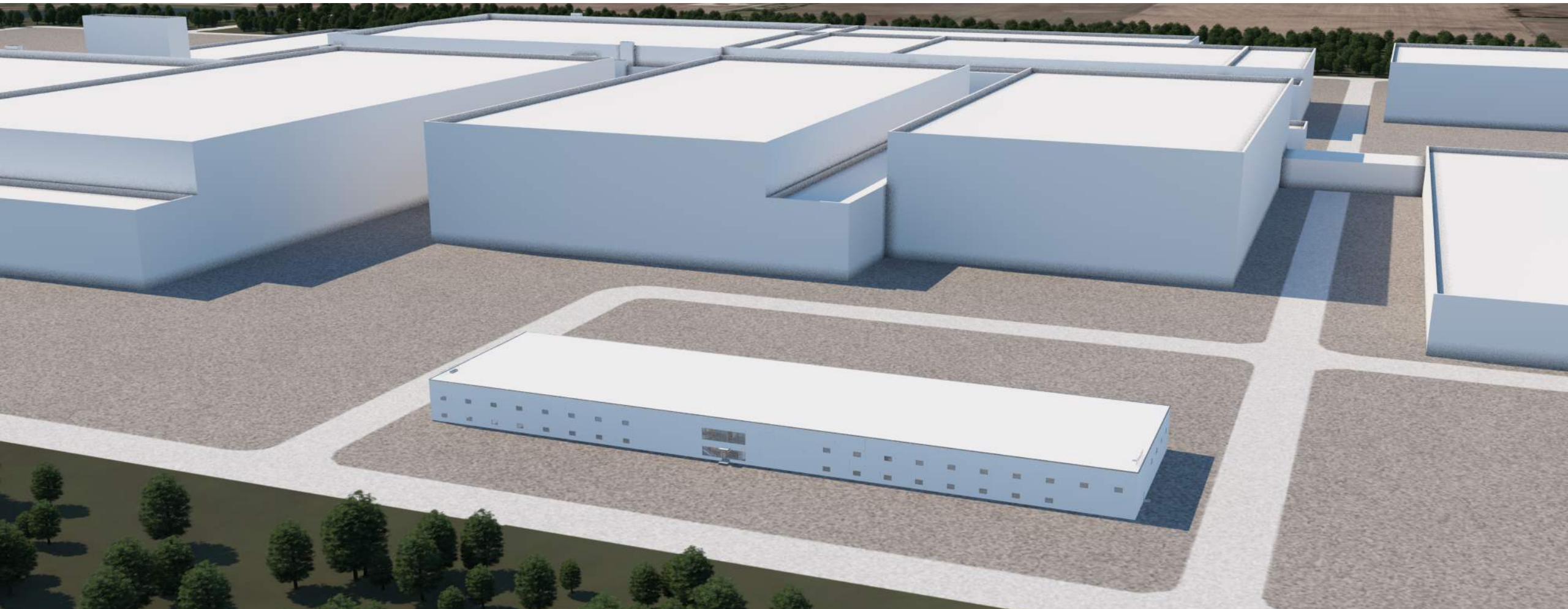

Near Term Construction Timeline

2018				2019	
Q1	Q2	Q3	Q4	Q1	Q2
Site Development					
		Multipurpose Building Construction			
			Major Material and Equipment Procurement Fabrication Facilities		
					Start Fabrication Facilities Building Construction

Procurement Process

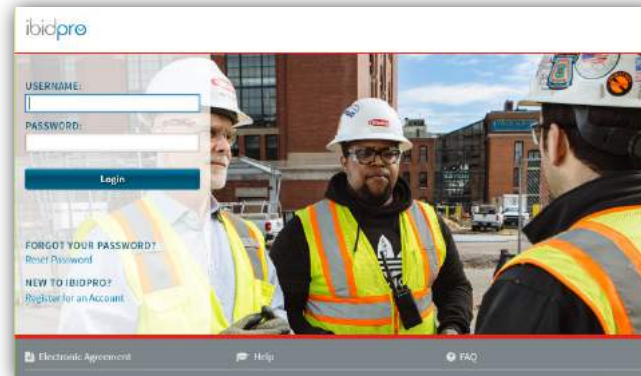

Wisconsin First and Racine County Economic Inclusion and Diversity Goals

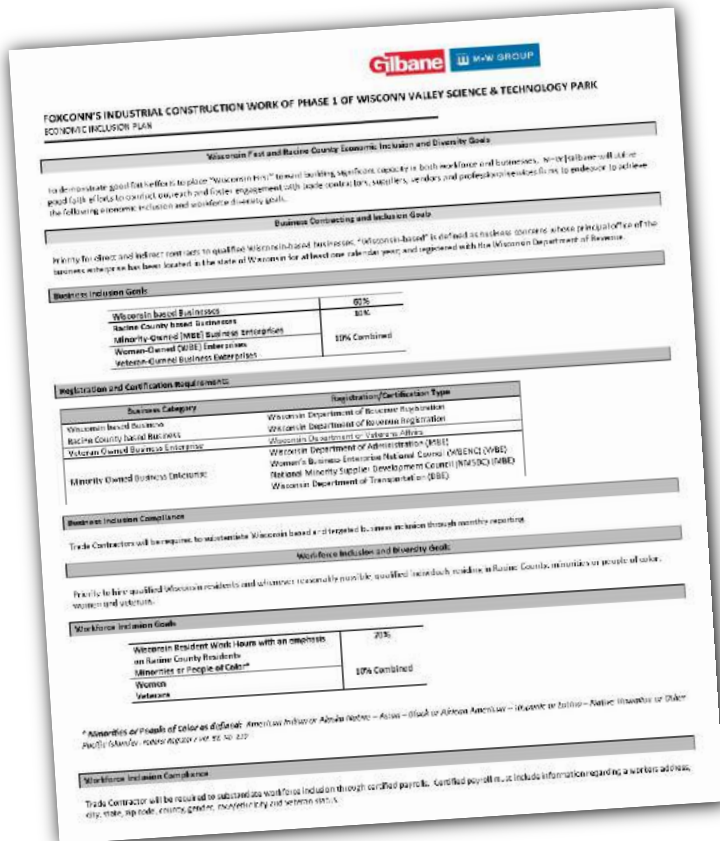

Business Contracting and Inclusion Goals

Wisconsin based Businesses	60%
Racine County based Businesses	10%
Minority-Owned (MBE) Business Enterprises	10% Combined
Woman-Owned (WBE) Enterprises	
Veteran-Owned Business Enterprises	

Workforce Inclusion and Diversity Goals

Wisconsin Resident Work Hours with an emphasis on Racine County Residents	70%
Minorities or People of Color*	10% Combined
Women	
Veterans	

Gilbane Building Company and M+W Group will deploy best efforts through robust outreach, procurement and construction practices to achieve the goals for the construction projects awarded for their work in the Science and Technology Park.

Next Steps Bid Releases

Release 1:	Ground Moving and Site Development	Completed Q1 2018
Release 2:	Multipurpose Facility	Completed Q2 2018
Release 3:	Site Utilities, Roadways, PSS, and Logistics	Q3-Q4 2018
Release 4:	Long Lead Material, Equipment, Systems	Q1-Q2 2019
Release 5:	Foundations and Underground Distribution	Q1-Q2 2019

Bid Release #3 – Bid invitations posted! Details

Utilities, Roadways, Power Substation (PSS) and Logistics – Q3-Q4 2018

- Site Utilities - Sanitary and Water
- Roadways - Curb and Gutter, Asphalt Paving, and Associated Storm Drainage
- Power Substation (PSS) – Building and Equipment
- Logistics:
 - Construction Materials Removal and Recycling
 - Temporary Toilets
 - Temporary Utilities
 - Site Security

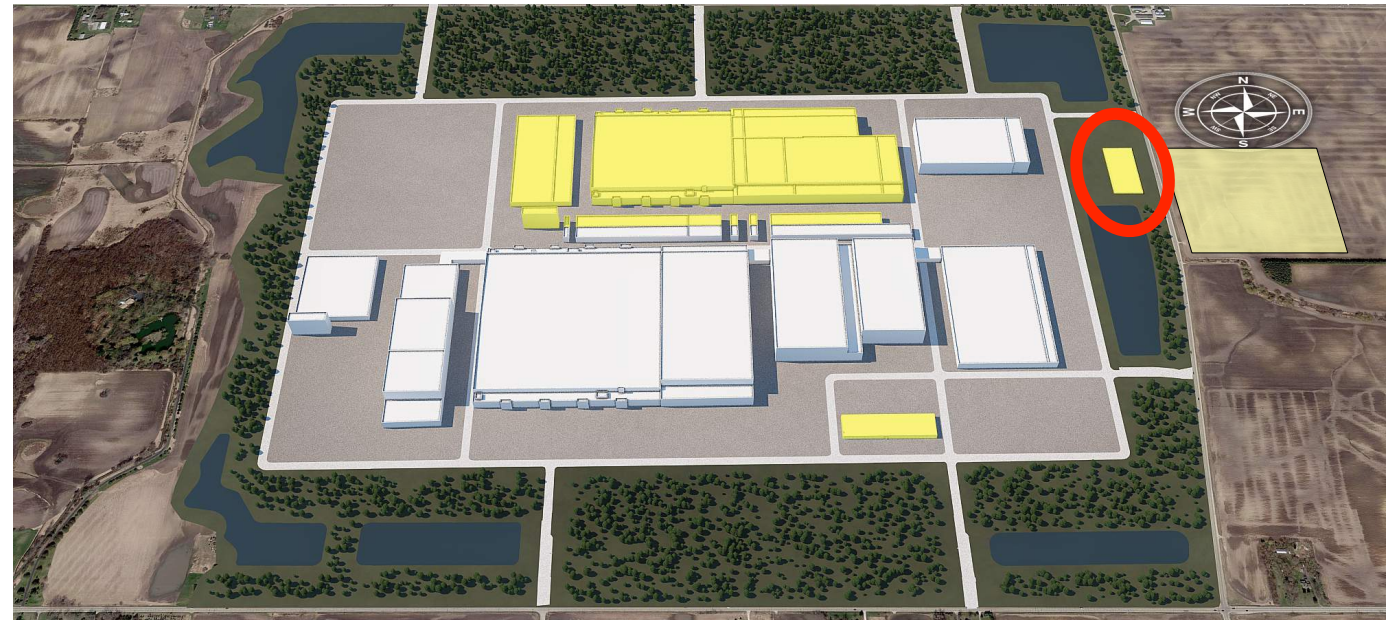

Bid Release #4

Details

Long Lead Material, Equipment, and Specialty Systems - Q1-Q2 2019

– Building Substructure & Structure

- Rebar
- Structural Steel
- Precast

– Building Enclosure

- Precast
- Metal Panels
- Aluminum and Glass
- Roofing

– Equipment

- Switchgear / HV Cabling
- Emergency Generators
- Chillers / Cooling Towers

– Specialty Systems

- Ultra Pure Water (UPW)
- Process Cooling Water (PCW)
- Chilled Water
- Hot Water
- Waste Water Treatment (WWT)
- Bulk & Specialty Gases / Chemicals
- Compressed Air & Dryers

Bid Release #5

Details

Foundations and Underground Distribution - Q1-Q2 2019

- Building Excavation
- Building MEP Underground Utilities
- Building Concrete Foundations

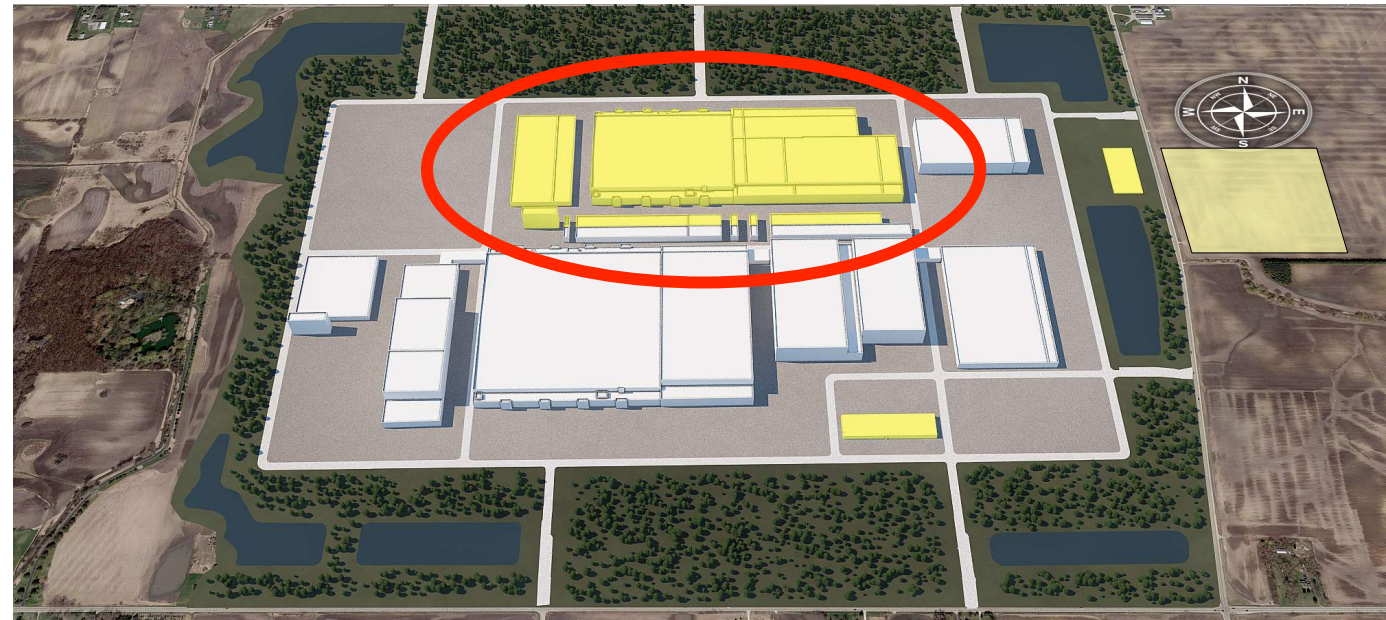

SITE PHOTOS



SITE PHOTOS



SITE PHOTOS



SITE PHOTOS



SITE PHOTOS



The background of the slide is a light gray gradient. It is decorated with numerous realistic water droplets of various sizes. Some droplets are at the top left, some are scattered in the middle, and a larger cluster of droplets is on the right side, with one particularly large, prominent droplet near the bottom right corner. The droplets have highlights and shadows, giving them a three-dimensional appearance.

WISCONSIN CONSTRUCTION SITE STORM WATER PERMITTING & ENFORCEMENT

WATER QUALITY PROTECTION



WISCONSIN STORM WATER QUALITY REGULATORY PROGRAM

- MUNICIPAL (MS4)
 - INDUSTRIAL FACILITIES
 - CONSTRUCTION SITES
- 

CONSTRUCTION PERMIT PROCESS

- **LANDOWNER RESPONSIBILITIES**
 - DEVELOP SITE SPECIFIC PLANS
 - CONSTRUCTION SITE EROSION CONTROL PLAN
 - POST-CONSTRUCTION STORM WATER MANAGEMENT PLAN
 - DNR – WATER QUALITY ONLY
 - MUNICIPAL – WATER QUALITY AND QUANTITY (FLOOD CONTROL-SEWRPC STUDY)
 - SUBMIT PERMIT APPLICATIONS TO REGULATORY AUTHORITIES
 - DNR
 - LOCAL MUNICIPALITY
- **REGULATORY AUTHORITY RESPONSIBILITY**
 - REVIEW PERMIT APPLICATION MATERIALS
 - CONTACT LANDOWNER REGARDING APPLICATION/PLAN DEFICIENCIES
 - ISSUE PERMIT

CONSTRUCTION PERMIT IMPLEMENTATION

- LANDOWNER RESPONSIBILITIES
 - DURING CONSTRUCTION
 - IMPLEMENT EROSION CONTROL PLAN
 - INSPECT EROSION CONTROL PRACTICES
 - MAINTAIN EROSION CONTROL PRACTICES
 - KEEP INSPECTION/MAINTENANCE REPORTS AND MAKE AVAILABLE TO REGULATORS
 - POST CONSTRUCTION (LONG-TERM)
 - IMPLEMENT LONG-TERM STORM WATER MANAGEMENT PRACTICES
 - INSPECT LONG-TERM STORM WATER MANAGEMENT PRACTICES
 - MAINTAIN LONG-TERM STORM WATER MANAGEMENT PRACTICES

CONSTRUCTION PERMIT IMPLEMENTATION

- REGULATORY AUTHORITY RESPONSIBILITIES
 - DURING CONSTRUCTION
 - CONDUCT ROUTINE EROSION CONTROL INSPECTIONS (MUNICIPALITY – MS4 PERMIT)
 - CONDUCT EROSION CONTROL INSPECTIONS BASED ON COMPLAINTS (DNR & MUNICIPALITY)
 - TAKE APPROPRIATE ENFORCEMENT ACTION WHEN NEEDED
 - POST CONSTRUCTION (MUNICIPAL)
 - REQUIRE OR CONDUCT ROUTINE INSPECTIONS OF LONG-TERM STORM WATER MANAGEMENT PRACTICES
 - TAKE APPROPRIATE ENFORCEMENT ACTION WHEN NEEDED



CONSTRUCTION PERMIT ENFORCEMENT

- STEPPED ENFORCEMENT PROCESS
 - NOTICE OF NON-COMPLIANCE
 - NOTICE OF VIOLATION
 - REFERRAL TO DEPARTMENT OF JUSTICE
 - ADDITIONAL MUNICIPAL ENFORCEMENT OPTIONS
 - STOP WORK ORDER
- 

Questions?

- Pete Wood, WDNR Storm Water Engineer

- Peter.Wood@wisconsin.gov

- Eric Ebersberger, WDNR

- Eric.Ebersberger@wisconsin.gov

FOXCONN MONTHLY PUBLIC MEETING

SEPTEMBER 17, 2018

WISCONSIN DEPARTMENT OF TRANSPORTATION

BRETT WALLACE, P.E.



NEW



SINCE LAST MEETING...

- Two projects lets :
 - I-94 north segment
 - Box culverts at Wisconn Valley Way and County KR









COUNTY G to COLLEGE AVENUE

I-94 NORTH SEGMENT

BEGAN LAST WEEK

- Expanding freeway to eight lanes with safety and operational improvements
- Rebuilding all existing bridges over local roads
- Reconstructing 7.5 miles
- Rebuilding 7 Mile Road interchange
- Constructing new interchange at Elm Road
- Permanent closing of South 27th Street ramps
- Bid cost \$161,597,372

Schedule Summary

	2018	Ryan Road Interchange reconstruction
	2018 – June 2019	Work zone prep and southbound I-94 reconstruction
	July – Dec 2019	Reconstruct northbound I-94
	2020	Median work between College Avenue and Ryan Road
	May 2020	COMPLETE



NEW

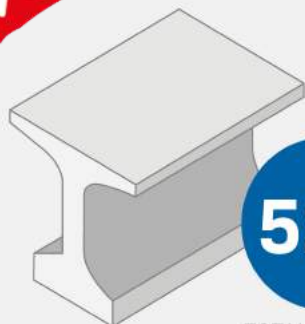

520

TOTAL GIRDERS

SOUTH SEGMENT - 309 Concrete Girders

CENTRAL SEGMENT - 84 Concrete Girders

NORTH SEGMENT - 127 Concrete Girders

**94 NORTH-SOUTH
FREEWAY PROJECT**
Plan Ahead. Drive Safely. Move Forward.



Crews place girders at Golf Road

I-94 CONSTRUCTION UPDATE

- Ryan Road bridge deck poured, traffic switch to new I-94 SB entrance and exit ramps expected late September
- Girder arrivals and placement underway at Kraut Road, Golf Road, County K, 58th Road, Braun Road, County KR, County A, County E, WIS 11
- Continue working on northbound pavement, concrete paving occurring this week



I-94 FREEWAY PROJECT AT A GLANCE

3 mainline segments

6 interchanges



18.5 miles

Delivery
of about

\$500 M

makes this the **FASTEST-PACED**
mega project in WisDOT history

>2
YRS



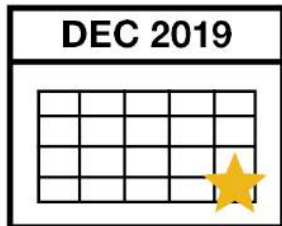

**Traffic on all
new pavement
by **end of 2019****

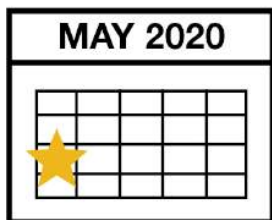

**All freeway lanes
open **Memorial
Day 2020****

WE ARE MAKING PROGRESS!

Currently, I-94 North-South is configured with two lanes of traffic in each direction between WIS 142 and County G.

SOUTH SEGMENT (WIS 142 TO WIS 20)

With two months down and only three to go in the current configuration, the next phase of work will open up a third lane of traffic in each direction!

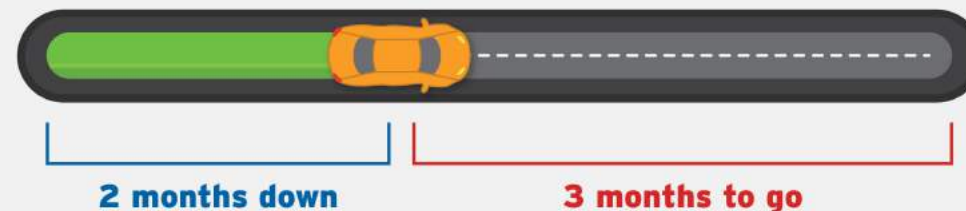

NEW

SERVICE TEAM MAKING A DIFFERENCE

- Wisconsin DOT State Farm® Safety Patrol are deployed on the I-94 North-South corridor
- Offer free, limited roadside assistance to drivers in need
- Goal is to enhance safety and mobility in work zones



**94 NORTH-SOUTH
FREEWAY PROJECT**
Plan Ahead, Drive Safely, Move Forward

The Freeway Service Team (FST) provides roadside assistance throughout the work zone. Since construction began, the FST has patrolled 21,000 miles in 660 hours and provided a total of 167 assists. The average response time is 16 minutes.

NEW

WISCONN VALLEY DEVELOPMENT ROADS CONSTRUCTION FORECAST		
Last updated: September 10, 2018		
INTERNATIONAL DRIVE		
Finished Project Work: <ul style="list-style-type: none">• Clearing• Drain tile exploration	Current Project Work: <ul style="list-style-type: none">• Diversion channel• Topsoil stripping	Upcoming Project Work: <ul style="list-style-type: none">• Box culvert• Pond construction
BRAUN ROAD		
Finished Project Work: <ul style="list-style-type: none">• Clearing• Diversion channel	Current Project Work: <ul style="list-style-type: none">• Structure excavation• Temporary widening	Upcoming Project Work: <ul style="list-style-type: none">• Box culvert• Begin construction of eastbound roadway
WIS 11/WILLOW ROAD		
Finished Project Work: <ul style="list-style-type: none">• Storm sewer• Pond• WIS 11 roadway grading	Current Project Work: <ul style="list-style-type: none">• WIS 11 concrete paving	Upcoming Project Work: <ul style="list-style-type: none">• Willow Road concrete paving• WIS 11 asphalt paving• Late September traffic switch on WIS 11

WISCONN VALLEY CONSTRUCTION UPDATE

- **International Drive:** Completed draintile exploration. Working on roadway embankment, box culvert installation and pond construction.
- **Braun Road:** Diversion channel, structure excavation and widening complete. Working on box culvert construction and will begin construction of eastbound roadway.
- **Willow Road/WIS 11:** WIS 11 westbound curb and gutter almost complete. Upcoming work includes Willow Road concrete paving, WIS 11 asphalt paving, traffic switch on WIS 11.
- County KR and Wisconn Valley Way box culverts preconstruction meeting soon.



Check out the weekly construction forecast posted every Monday



ENVIRONMENTAL STEWARDSHIP

- Early and extensive coordination with agencies and local municipalities
- U.S. Army Corps of Engineers and WI Department of Natural Resources (DNR) identified I-94 and Wisconn Valley Development Roads as priority projects
- Early decision to mitigate wetlands at 2:1 ratio
- Contributing ILF credits partnering with WI DNR to identify watershed improvements



Newly constructed stream diversion channel at Braun Road



ENVIRONMENTAL STEWARDSHIP

EROSION CONTROL

- WisDOT established an erosion control leader
 - Completes inspections, issues orders and maintains all records
 - Completes rainfall inspections of all active construction projects
 - Schedules routine site visits and meetings with the WIDNR to review priority erosion control items
 - Any concerns are promptly addressed with the various contractors through erosion control orders
 - WisDOT coordinates erosion control efforts with adjacent private developments



ENVIRONMENTAL STEWARDSHIP EXAMPLE

I-94 and WIS 11 interchange:

- WDNR and WisDOT worked to minimize impacts to threatened and endangered species
- Two methods were utilized to mitigate impacts to state threatened prairie and purple milkweed
 1. Relocate 1 acre of high quality prairie and milkweed sod to Richard Bong Recreation Area
 2. Plant native seed along with threatened and endangered species seed mix in two pond areas

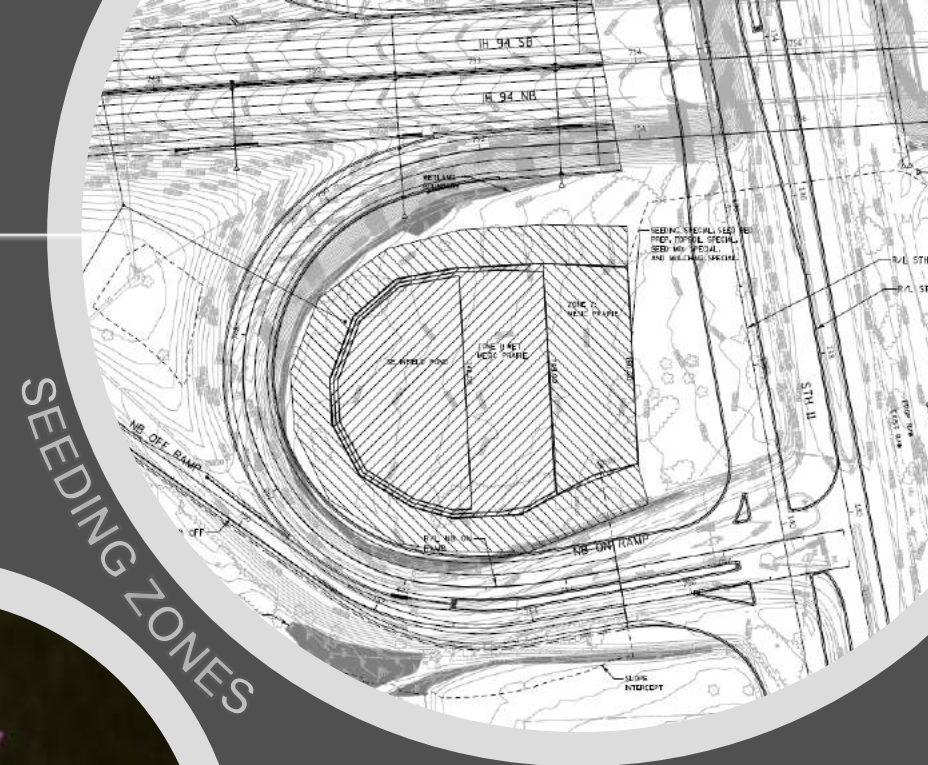

PRAIRIE MILKWEED



PURPLE MILKWEED



ENVIRONMENTAL STEWARDSHIP

I-94 and WIS 11 interchange prairie restoration

- Loaded sod onto pallets and transported by semi-truck/trailer
- Moved immediately to DNR Richard Bong State Recreation Area in Kenosha County
- DNR currently monitoring

SOD TRANSPORT



NEW LOCATION



FLOODPLAIN ANALYSIS

- SEWRPC June 2018 Report
- Assessed impacts of development on receiving streams
- SEWRPC projected full-build stormwater quantity flow for the Des Plaines to ensure that roadway and development stormwater management improvements are effective



Revised SEWRPC Buildout Land Use for the Kilbourn Road Ditch Subwatershed - Mount Pleasant EITM Floodplain Evaluation

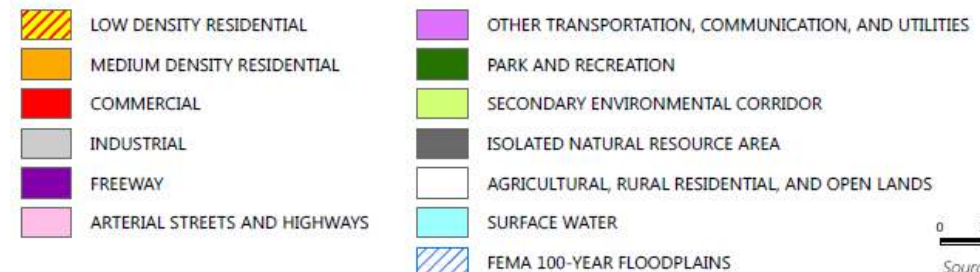
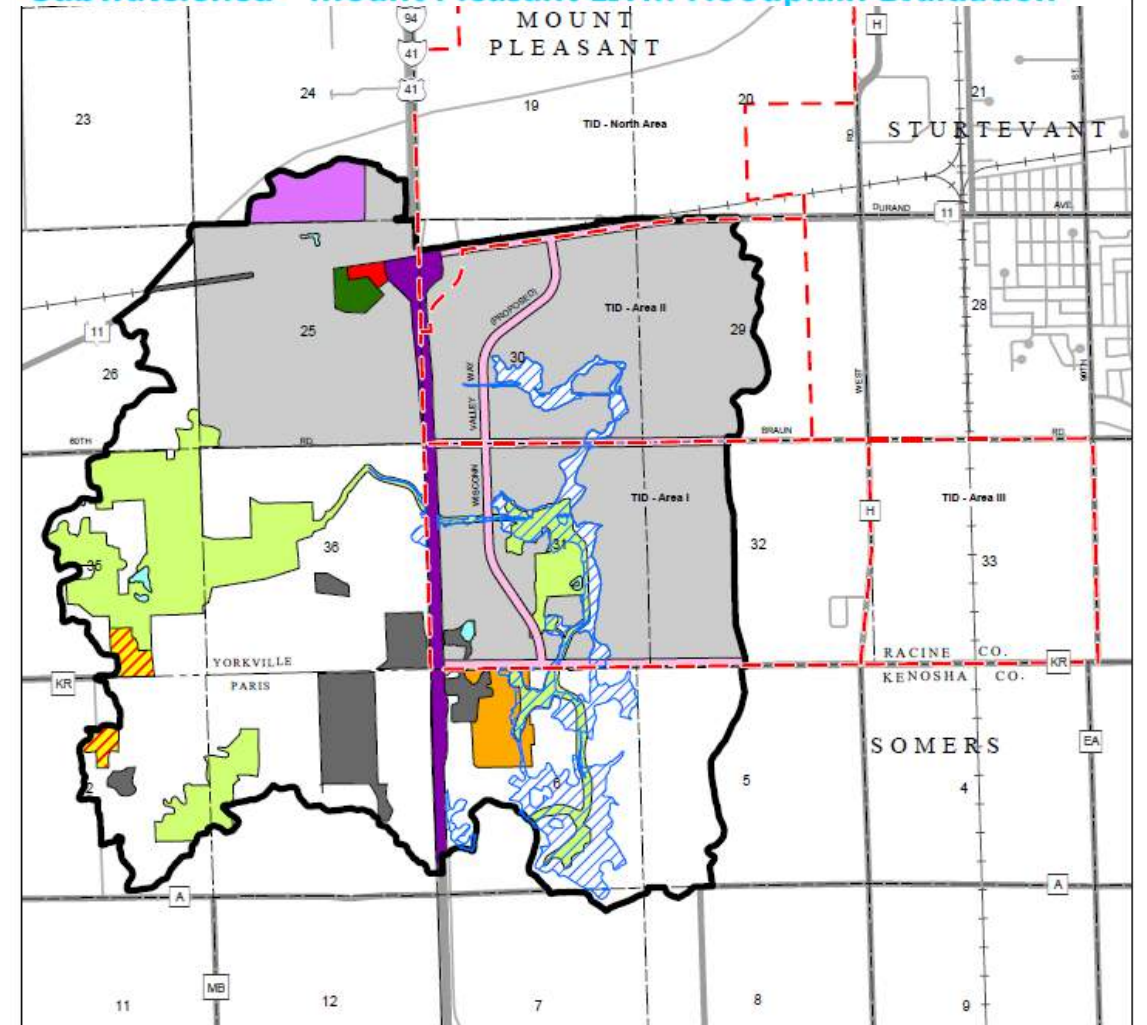



projects.511wi.gov/



twitter.com/WisconsinPlan94



facebook.com/WisconsinPlan94

STAY CONNECTED

WisDOT commits to:

- Communicating early and often
- Listening and responding to issues
- Conducting on-going business meetings and monthly construction updates